

Nina Chomsky  
1500 Lancashire St.  
Pasadena, CA 91103  
September 23, 2020

Chair Felicia Williams and Planning Commissioners  
Planning Commission Meeting 9/23/2020  
Agenda Item 5.B. Surplus Property Declaration – YWCA and Civic Center

Chair Williams and Planning Commissioners,

I am writing in my individual capacity with additional information on the open spaces and civic gardens that form the historic approaches to and setting of Pasadena's Beaux Arts City Hall, and which open spaces and gardens are publicly owned land used and enjoyed by the public for nearly 100 years.

These open spaces and gardens are located on both sides of Holly St. and front on Garfield, and are encompassed within Parcel 3 on the YWCA site, and also within Parcel 3 on the north side of Holly St. Both of these currently open space and garden Parcels are illustrated on the attached Civic Center Parcel Map. Note: in the tradition of Beaux Arts design, the two Parcel 3s mirror each other forming a symmetrical set of open spaces and gardens that together form the historic approaches, including visual approaches, to and setting of City Hall. These open spaces and gardens on both sides of Holly are character defining features of the Pasadena Civic Center National Register District.

No development or construction should take place on either Parcel 3 in order to preserve these historic open spaces and civic gardens. **To this end, I respectfully urge you not to declare either Parcel 3 as Surplus Land for private development.** Any sort of future development should be limited to the balance of land on the YWCA site and across Holly to the north.

Thank you for your attention to my comments.

Nina Chomsky

2013



MAPPING AND GIS SERVICES SCALE 1" = 100'

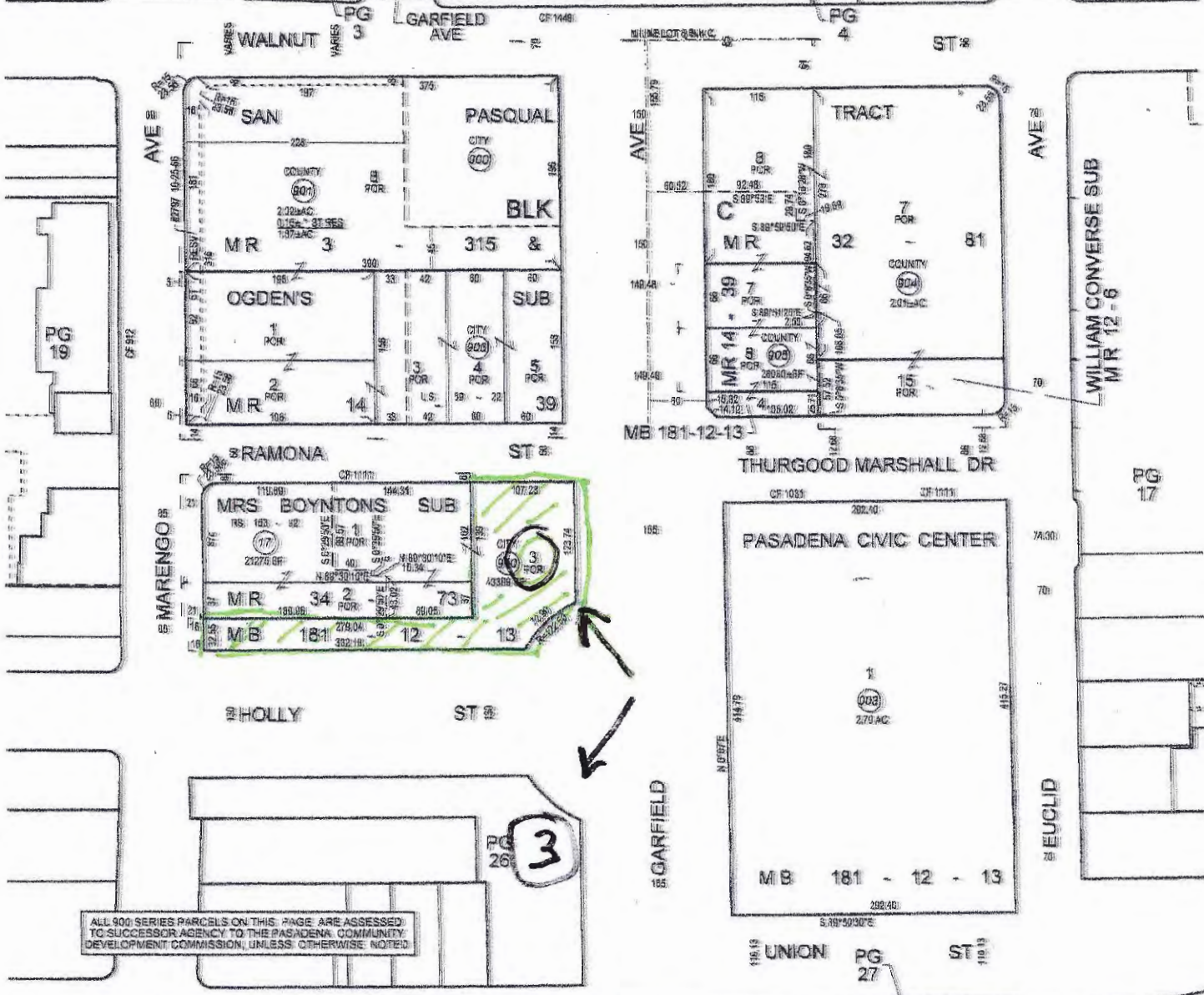

ALL 900 SERIES PARCELS ON THIS PAGE ARE ASSESSED TO SUCCESSOR AGENCY TO THE PASADENA COMMUNITY DEVELOPMENT COMMISSION, UNLESS OTHERWISE NOTED

ATTACHMENT