

OWNER/SUBDIVIDER:  
814 MAGNOLIA LLC  
1032 ENCANTO DR.,  
ARCADIA, CA 91007

PREPARED BY:  
HANK JONG, PE  
EGL ASSOCIATE, INC.  
11819 GOLDRING ROAD, UNIT A  
ARCADIA, CA 91006  
TEL: 626-263-3588  
FAX: 626-263-3599

NOTES:  
ZONING: R3 (PRESENT)  
ZONING: R3 (PROPOSED)  
APN: 5720-025-003  
NO. OF EX. LOT: 1  
NO. OF PROP. LOT: 1  
NO. OF EX. UNITS: 1  
NO. OF PROP. UNITS: 7  
NO. OF PROP. PARKING: 14 (GARAGE)  
NO. OF PROP. FLOORS: 3 STORIES + BASEMENT  
AREA OF LOT: 10,008 SQ. FT. (0.29 ACRE)  
\*NO EASEMENT ON SITE.

UTILITY SERVICES:  
WATER ----- CITY OF PASADENA WATER & POWER DIVISION  
SEWER ----- CITY OF PASADENA PUBLIC WORKS  
GAS ----- SOUTHERN CALIFORNIA GAS CO.  
ELECTRICAL ----- CITY OF PASADENA WATER & POWER DIVISION  
TELEPHONE ----- AT&T  
SCHOOL ----- PASADENA CITY SCHOOL DISTRICT  
FIRE ----- CITY OF PASADENA FIRE DEPARTMENT  
POLICE ----- CITY OF PASADENA POLICE DEPARTMENT

BENCHMARK:  
CITY BENCHMARK #618/58  
BOLT CRC NW COR LOS ROBLES & CALIFORNIA  
ELEV 780.67  
SURVEY WAS PROVIDED BY ALFRED J. THELWELL,  
LS 6999 ON MAY 1, 2019

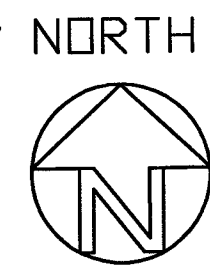

SCALE: 1"=10'

# TENTATIVE TRACT NO. 83373

IN THE CITY OF PASADENA, COUNTY OF LOS ANGELES, STATE OF CALIFORNIA  
BEING A SUBDIVISION OF LOT 3 OF MAGNOLIA TRACT AS PER MAP RECORDED IN BOOK 5 PAGE 145 OF MAPS,  
IN THE OFFICE OF THE COUNTY RECORDER OF SAID COUNTY.

FOR CONDOMINIUM PURPOSES

## IMPROVEMENT NOTES

- ① CONSTRUCT DRIVEWAY APPROACH.
- ② CONSTRUCT 6" VCP SEWER LATERAL CONNECTING TO EXISTING SEWER STUB.
- ③ CONSTRUCT SEWER CLEANOUT.
- ④ EX. WATER METER TO REMAIN.
- ⑤ CONSTRUCT NEW WATER METER & SERVICES.
- ⑥ CONSTRUCT DECK DRAIN.
- ⑦ CONSTRUCT TRENCH DRAIN.
- ⑧ CONSTRUCT CATCH BASIN.
- ⑨ CONSTRUCT DRAINAGE PIPE.
- ⑩ PROPOSED SUMP PUMP.
- ⑪ CONSTRUCT INFILTRATION SYSTEM.

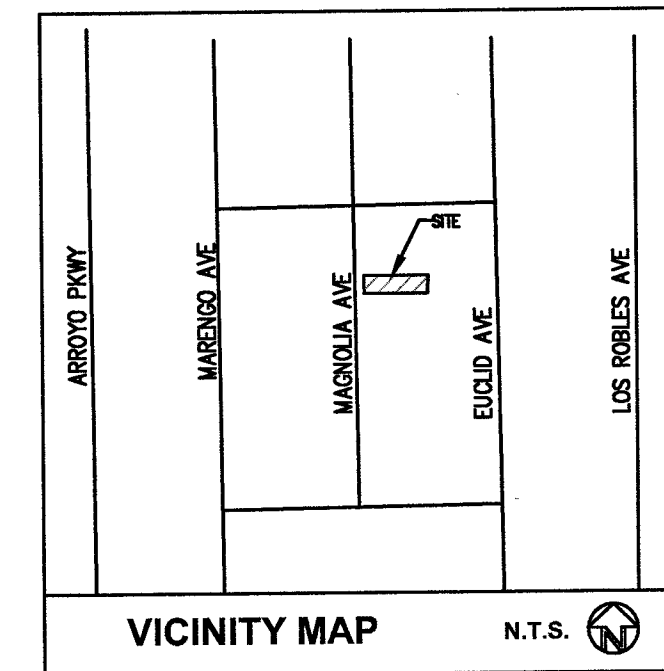

DEMOLISHING NOTES:  
⊗ EX. STRUCTURE TO BE REMOVED  
⊙ EX. TREE TO BE REMOVED  
⊚ EX. DRIVEWAY APPROACH TO BE REMOVED

## TREE INVENTORY

TREE#	COMMON NAME	DBH (IN)	HEIGHT (FEET)	PROTECT STATUS	HEALTH	DISPOSITION
TR #1	CITRUS	6"	5'	NO	GOOD	REMOVE

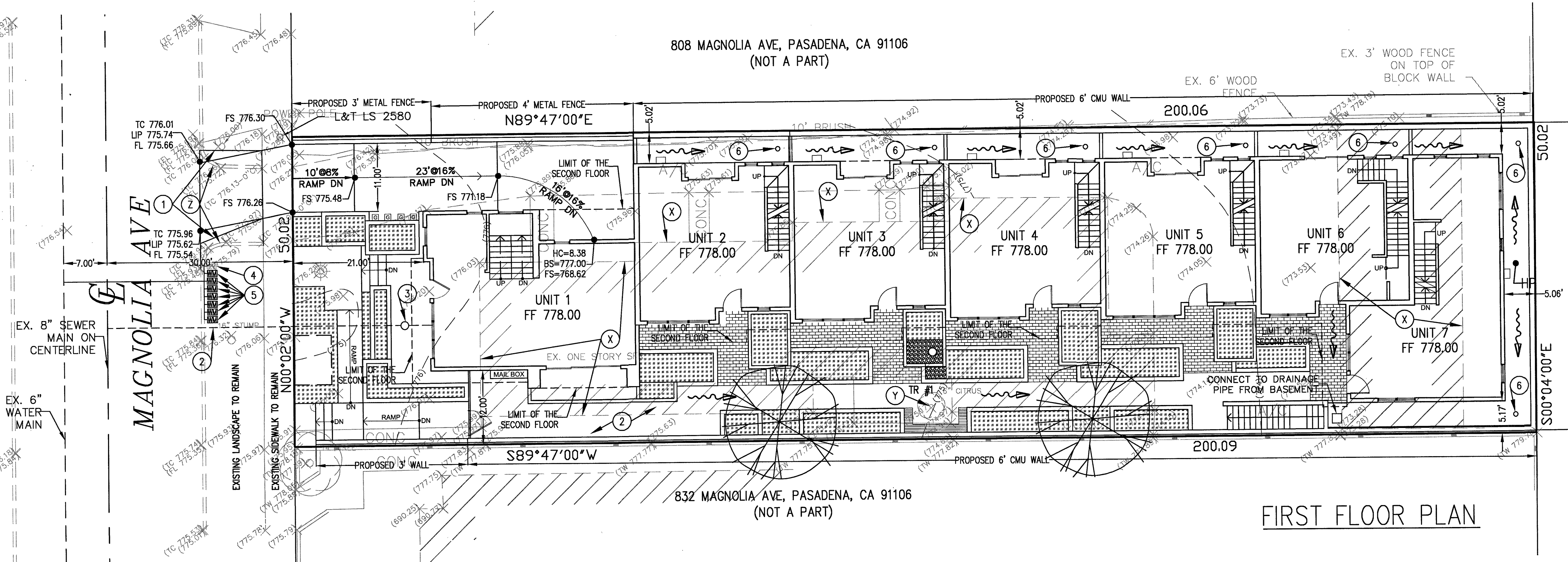

FIRST FLOOR PLAN

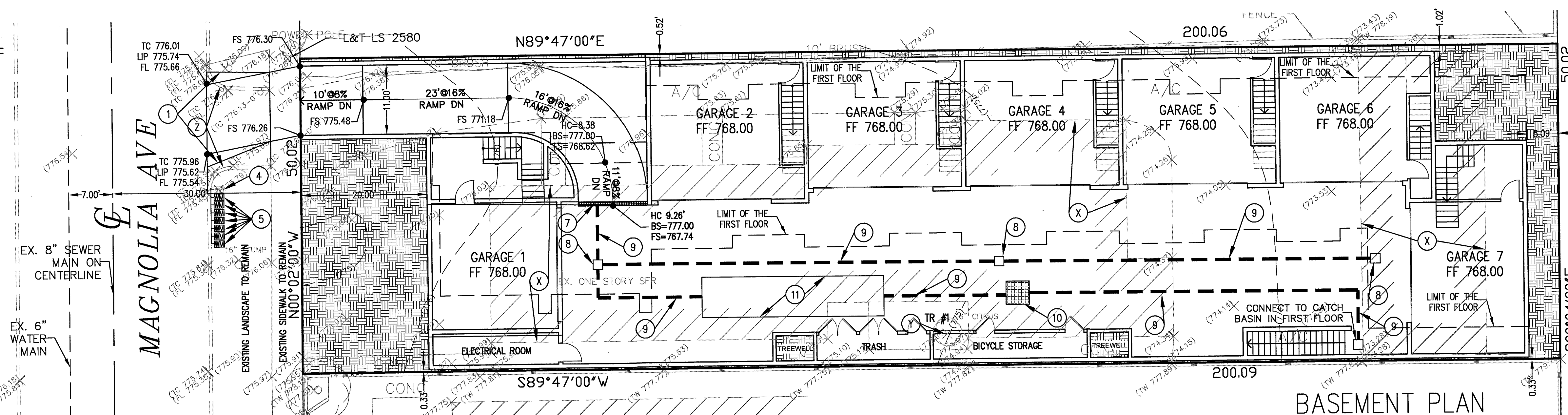

BASEMENT PLAN

## LEGEND

- (527.63)...EXISTING ELEVATION
- 520.00...PROPOSED ELEVATION
- (5.30)...EXISTING CONTOUR
- ...DRAINAGE PATTERN
- ...PROPOSED STRUCTURE
- ...PROPOSED BLOCKWALL
- ...PROPOSED SEWER
- ...CATCH BASIN
- ...EXISTING STRUCTURES TO BE REMOVED
- ...PROPOSED PLANTER
- ...PROPOSED WALKWAY
- FL...FLOW LINE
- FG...FINISH GRADE
- FF...FINISH FLOOR
- HP...HIGH POINT
- B/W...BACK OF SIDEWALK
- EX...EXISTING
- TG...TOP GRADE
- FS...FINISH SURFACE
- BS...BOTTOM SLAB
- HC...HEAD CLEARANCE

PROJECT LOCATION:

**7-UNIT CONDOMINIUM**  
**814 MAGNOLIA AVE.,**  
**PASADENA, CA 91106**

These drawings and the accompanying specifications are the property of EGL Associates, Inc. No part of these drawings or specifications may be reproduced or transmitted in any form or by any means, electronic, mechanical, photocopying, recording, or by any information storage and retrieval system, without the prior written permission of EGL Associates, Inc. Any unauthorized use of these drawings or specifications is prohibited. EGL Associates, Inc. is not responsible for any errors or omissions in these drawings or specifications. EGL Associates, Inc. is not responsible for any damage or injury resulting from the use of these drawings or specifications. EGL Associates, Inc. is not responsible for any damage or injury resulting from the use of these drawings or specifications. EGL Associates, Inc. is not responsible for any damage or injury resulting from the use of these drawings or specifications.

REVISIONS BY

RELEASED DATE

PREPARED FOR:  
**814 MAGNOLIA LLC**  
**1032 ENCANTO DR.,**  
**ARCADIA, CA 91007**  
**(626) 688-6359**



**EGL Associates, Inc.**  
11819 GOLDRING ROAD, Unit A  
ARCADIA, CA 91006  
Tel: (626) 263-3588  
Fax: (626) 263-3599

DRAWN SH  
CHECKED HJ  
DATE 01/22/2021  
JOB NO. 19-227-001  
SCALE 1"=10'  
FILE  
DRAWING 1 of 1

**T-1**