

D 2 S.

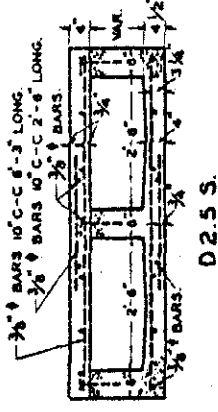

D 2.5 S.

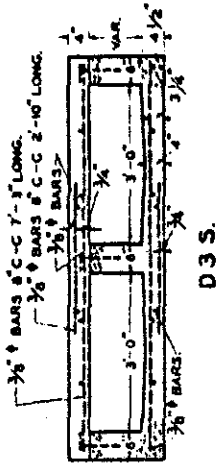

D 3 S.

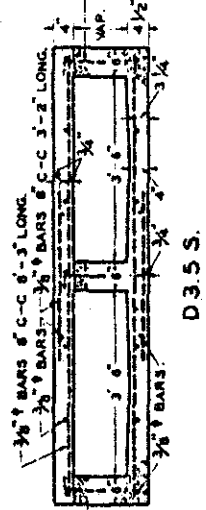

D 3.5 S.

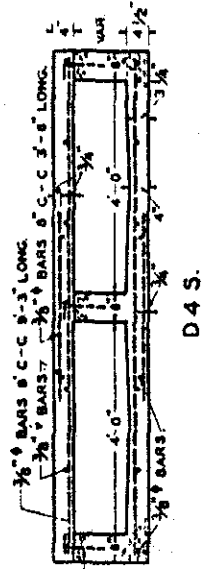

D 4 S.

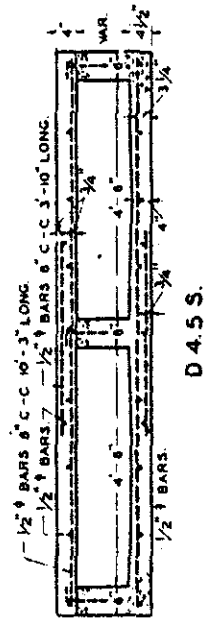

D 4.5 S.

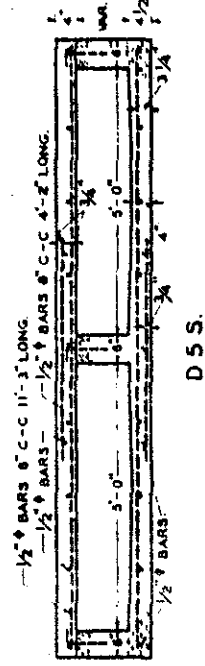

D 5 S.

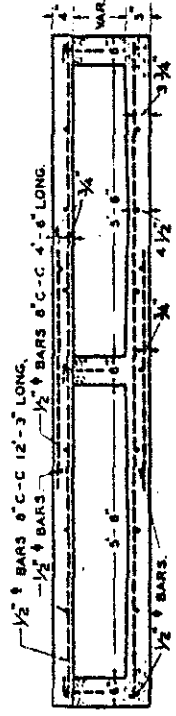

D 5.5 S.

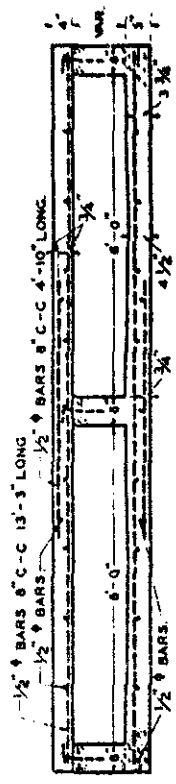

D 6 S.

CONSTRUCTION JOINT.

— DOWEL BARS (SEE NOTE BELOW)

NOTE: TRANSVERSE STEEL IN BOTTOM SLABS TO BE SAME LENGTH AND SIZE AS IN TOP SLABS BUT AT TWICE THE SPACING.
 12" $\frac{1}{2}$ " DOWEL BARS, 3" BEND AT TOP, SET 12" C-C ON CENTER LINE OF WALL AND EXTENDING DOWN 7" INTO WALL.
 CULVERT SECTIONS SHOWN ABOVE ARE DESIGNATED AS FOLLOWS:-
 D 2 S DENOTES A 2'-0" DOUBLE SIDEWALK CULVERT BOX.
 D 3.5 S DENOTES A 4'-6" DOUBLE SIDEWALK CULVERT BOX, ETC.

CITY OF PASADENA
 OFFICE OF CITY ENGINEER
STANDARD
DOUBLE BOX CULVERTS
FOR SIDEWALKS.
 APPROVED BY *W. H. ...*
 ASSISTING ENGINEER, CHECKED BY *D.C.M.*
 SUBMITTED BY *J.C. ...*
 CITY ENGINEER'S OFFICE OF STREETS
 DATE, MAY 3, 1922
S-106